

# Straight type Low Profile Coupler for Silicon photonics

Bend the Light instead of Bending the Fiber

Application : Low loss surface coupling

Height : 2.5mm

High Accuracy of beam spacing :  $250 \pm 1 \mu\text{m}$

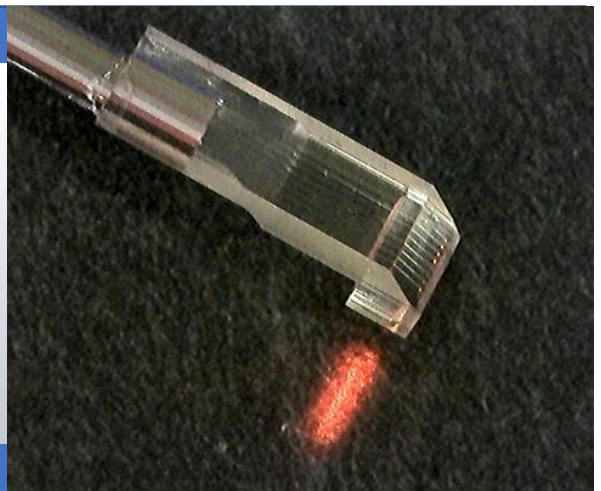
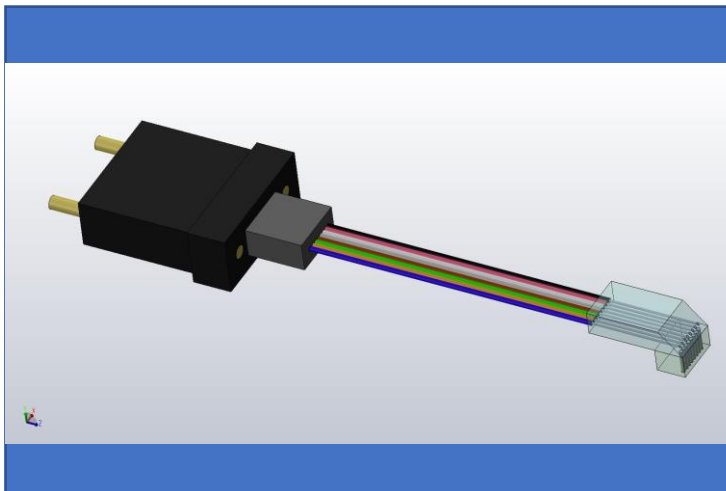

Nakahara Opto-Electronics Labs., Inc.

4282-3, Sakado, Mito, Ibaraki 310-0841 Japan

Contact : [info@noel-sekiei.co.jp](mailto:info@noel-sekiei.co.jp)

NOEL

© 2023 NOEL